

Pinch Fix Bracket, Railless

AXE_AL_BR_PF_RL

Durable

Non-corrosive materials for the toughest environmental conditions. Strength and integrity testing done.

Innovative

Integrated rail for seamless clamp connection. Optimal ventilation with 100mm clearance between PV module and roof.

Versatile

Attach to wide variety concealed fix roofs.

Effortless

Convenient installation with accessible fasteners for saving installation time. No sheet penetration needed.

Dimensions



L 80mm * W 47mm *
H 66mm
266g

Application	Roof Top – Railless
Roof types	Brownbuilt Craft-Lok Dimondek Consult for other roof manufacturers
Test protocol	Structural analysis to obtain reaction forces for each possible scenario. Pull tests on clamped bracket FEM analysis on part under load
Materials	<u>Fasteners:</u> Stainless Steel (A2) “Available in Stainless steel (A4)” <u>Body:</u> Extruded aluminium (6063 T6) Anodised with 15µm layer “Anodising available in 25µm layer”
Length	80mm for maximum support to the PV module and to give the installer flexibility on bracket positioning
Manufactured	100% South African produce and fabricated
Warranty	10 years ¹

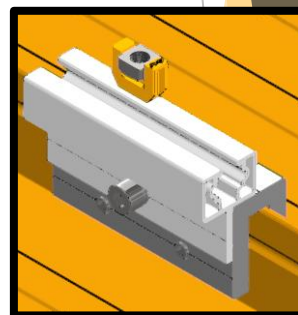
Integration with Fasteners

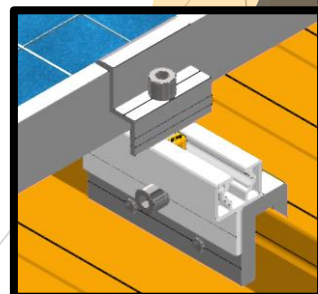

Integration with PV module connection



¹ For terms and conditions please refer to the Axe Struct Warranty Terms.