

## Pinch Fix Bracket, Vertical

AXE\_AL\_BR\_PF\_V

### Durable

Non-corrosive materials for the toughest environmental conditions. Strength and integrity testing done.

### Innovative

Integration with angled solution. Connection holes on side and top of bracket for connections to standing rib and horizontal rib.

### Versatile

Attach to wide variety concealed fix roofs. Fixation of Angled Systems.

### Effortless

Convenient installation with accessible fasteners for saving installation time. No sheet penetration needed.

### Dimensions

  
L 60mm \* W 35mm \*  
H 45mm  
185g

Application	Roof Top – Angled Frames (Railed or Railless)
Roof types	Brownbuilt Craft-Lok Dimondek Consult for other roof manufacturers
Test protocol	Structural analysis to obtain reaction forces for each possible scenario. Pull tests on clamped bracket FEM analysis on part under load
Materials	<u>Fasteners:</u> Stainless Steel (A2) “Available in Stainless steel (A4)”  <u>Body:</u> Extruded aluminium (6063 T6) Anodised with 15µm layer “Anodising available in 25µm layer”
Length	80mm for optimal roof contact and maximum strength
Manufactured	100% South African produce and fabricated
Warranty	10 years <sup>1</sup>

### Integration with Angled Systems

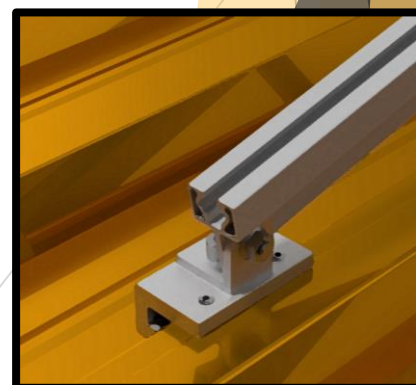
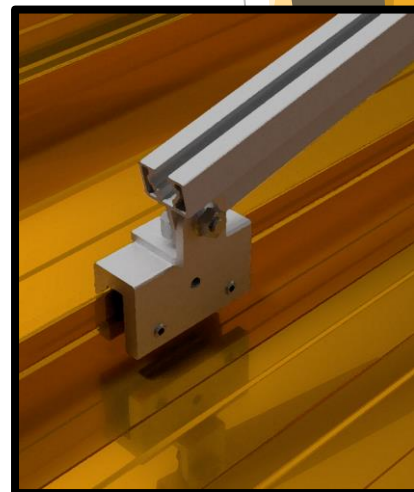
<sup>1</sup> For terms and conditions please refer to the Axe Struct Warranty Terms.